

DocuCentre S2520/S2320



DocuCentre S2520/S2320

A3 Monochrome Multifunction Device

The perfect solution for small- and medium-sized businesses

FUJI xerox 

A3 Monochrome Desktop Digital Multifunction Device: Improve efficiency packed with excellent functionality.

Combining high productivity with eco-friendly operation.



Copy Print

B/W:25/23ppm
Max:A3

Scan

B/W:28/25ppm
Colour:28/25ppm

Net Work

Ethernet
100BASE-TX/
10BASE-T

A compact multifunction device equipped with all the essentials to take on any office task.



High Productivity

Speedy operation

Accelerate office workflows with high-speed output

Take advantage of high speed copying at 25 pages/minute simplex and 18 pages/minute duplex*. The DocuCentre S2520/S2320 will accelerate your office workflow with a fast First Copy Output Time of 6.5 seconds and boasting a warm-up time of only 19 seconds.

* DocuCentre S2520. 23 pages/minute simplex and 17 pages/minute duplex with DocuCentre S2320.

Convenient ID card copy function

The ID card copy function saves time by making it possible to copy two sides of IDs onto just one piece of paper.

ID Card

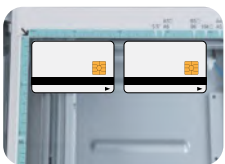

Front

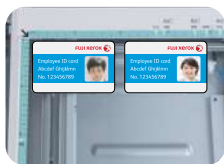

Back

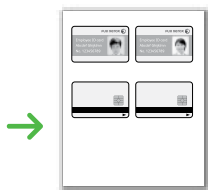

2 sides on one piece of paper

Improve productivity with fast colour scanning

Enjoy fast scans at 28 pages/minute*, which significantly reduces time spent digitizing large documents resulting in higher productivity.

* DocuCentre S2520. 25 pages/minute with DocuCentre S2320.

Print multiple pages on one sheet

Print up to eight pages onto a single sheet of paper, allowing you to reduce your paper usage.

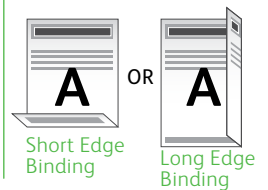
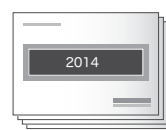

Fax more effectively. (Optional)

Send faxes quickly

Register up to 30 numbers for speed dial. It is also possible to receive legal size documents (8.5x13"/8.5x14") on one sheet of paper.

Fax redial button available

A list of recent transmissions will be displayed upon pressing the redial button. Simply select the desired recipient to resend a document.



Redial button

Simple fax broadcast function

Using fax broadcast allows you to send a document to a group of recipients quickly, eliminating repetitive tasks when sending the same document to multiple destinations.

Eco-friendly Operations

Environmental compliance with internationally recognized standards

The amount of ultrafine particles (UFPs*) emitted during continuous printing has been reduced by optimising operational settings.

* Ultrafine particles (UFPs) are tiny particulates less than 100 nanometres in diameter. They are far smaller than the PM2.5 particle class, the regulations for which are becoming stricter from an environmental perspective.

Adjustable toner output

Reduce your toner consumption depending on print requirements. The toner density is adjustable with six different settings.



Eco-friendly and energy saving

DocuCentre S2320 achieves 1.4kWh*1 for TEC value*2, conforming with the strict standards of International Energy Star Program and reducing power consumption.

*1 1.5kWh: DocuCentre S2520.

*2 Value measured by the test defined in International Energy Star Program.

Reusing Toner

Waste toner is collected for recycling. A waste toner bottle is now no longer required because the collected toner is reused in this eco-friendly system.

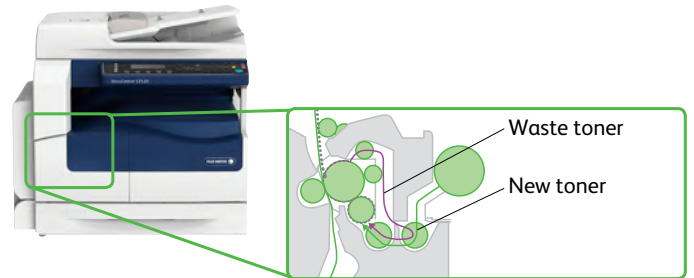

Convenient Features

Two scanning methods

Choose from two ways to scan, depending on where you are: Pull scan from a PC, or Push scan when at the device. When using Push scan, you can select a resolution between 200 and 600 dpi.



Rotate collating can be done easily

The rotate collate function can be used to assemble multiple copies of the same document in alternating horizontal-vertical orientation by loading the same size paper into two tiered trays (Portrait and Landscape), or into either Portrait or Landscape tray and Bypass Tray.



Print and copy on heavy paper

Printing of certificates or greeting cards on 60-216gsm paper can be done in-house easily, eliminating the need to outsource printing jobs.

Simple Business Solutions*

*optional

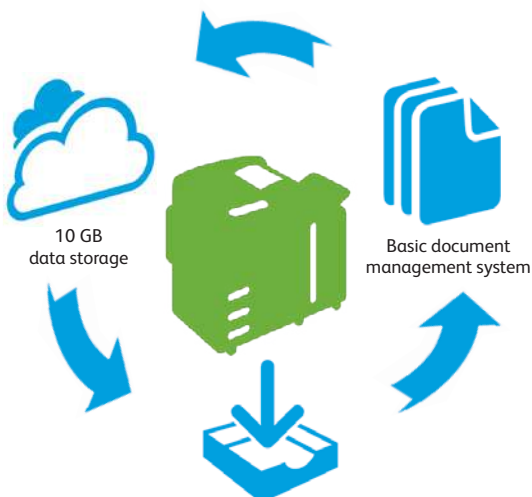

Cloud storage and document management

You can now streamline your workflow with our cloud solutions – Working Folder, DocuWorks and DocuWorks Tray.

Working Folder provides 10GB of secured cloud data storage with data encryption allows you to instantly digitize and access documents for archival and retrieval.

DocuWorks is a virtual desk allowing users to view, edit, share, collate, document on a manageable platform. Together with DocuWorks Tray (a graphical displayed tray), you can now receive instant notifications for incoming faxes or documents.

Machine Configurations

This modular machine allows you to choose from desktop to floor standing versions.



Standard desktop version



With optional One Tray Module



With optional One Tray Module and Cabinet (for storage)



With optional One Tray Module and Two Tray Module

DocuCentre S2520/S2320 Functions & Specifications

Basic Function / Copy Function

Item	Description	
	DocuCentre S2520	DocuCentre S2320
Type	Desktop	
Memory capacity	512 MB (Max : 512 MB)	
Scan Resolution	600 x 600 dpi	
Print Resolution	600 x 600 dpi	
Warm-up Time	19 seconds or less (20 degrees Celsius room temperature)	
Original Size	Maximum of 297 x 432 mm (A3,11 x 17") for both Sheet and Book	
Paper Size	Max	297 x 432 mm, A3, 11 x 17", Bypass Tray : 297 x 432 mm, A3, 11 x 17"
	Min	A5, Bypass Tray : 127 x 98 mm
	Image loss width	Lead Edge : 5.5 mm, Trail Edge : 6.0 mm, Right & Left Edges : 5.5 mm
Paper Weight ¹	Tray 1	60 to 90 gsm
	Tray 2, 3, 4 (Option)	60 to 216 gsm
	Bypass Tray	60 to 216 gsm
First Copy Output Time	6.5 seconds or less (A4 LEF)	
Continuous Copy Speed ²	A4 LEF/B5 LEF	25 ppm, In Duplex : 18 ppm
	A4	16 ppm, In Duplex : 10 ppm
	B4	15 ppm, In Duplex : 9 ppm
	A3	13 ppm, In Duplex : 8 ppm
Paper Tray Capacity ³	Standard	Tray1 : 250 sheets , Bypass Tray : 100 sheets
	Optional	One Tray Module (Tray2) : 500 sheets Two Tray Module (Tray3 + Tray4) : 1000 sheets
	Max	1850 sheets (Tray1 + Tray2 + Tray3 + Tray4 + Bypass Tray)
Output Tray Capacity ³	250 sheets (A4 LEF)	
Power Source	AC220-240 V +/- 10 % , 6 A, 50 / 60 Hz common	
Maximum Power Consumption	AC 220V: 1.3kW or less AC 240V: 1.4kW or less Low Power mode: 14W or less Sleep mode: 2W or less	
Dimensions	W 595 x D 584 x H 569 mm	
Weight ⁴	33 kg	

*1: It is recommended to use Fuji Xerox recommended paper. Correct print output may not be possible depending on the requirement. *2: The speed may be reduced due to the image quality adjustment. The performance may be reduced depending on the paper type. *3: When Using 80 gsm paper. *4: Excluding Toner Cartridge.

Fax Function (Optional)

Item	Description
Original Size	Max : A3
Recording Paper Size	Max : A3, Min : A4
Transmission Time*	2 seconds and more but fewer than 3 seconds
Transmission Mode	Super G3 / G3 ECM / G3 (ITU-T)
Applicable Lines	PSTN / PBX, 1 port

*: When A4 size document with approximately 700 characters is transmitted in standard image-quality (8x3.85 lines/mm) and in high-speed mode (28.8kbps or faster, JBIG). Only indicates the time for transmitting the image information and does not include the communication control time. The total communication time will vary depending on the contents of the document, the type of machine receiving the fax, and line condition.

Notes

- 1) If the storage media (such as hard disk drives) of the base unit fail, loss of received data, accumulated data, registered setting data, etc. may occur. In no event shall Fuji Xerox be liable for any damages whatsoever arising from loss of data.
- 2) Functional spare parts will be available for at least 7 years after the product is no longer manufactured.
- 3) The product specifications, appearance and other details in this catalog are subject to change without notice for improvements.

Other company names or product names are registered trademarks or trademarks of each company.

Reproduction Prohibitions Please note that reproduction of the following is prohibited by law : Domestic and foreign currencies, government-issued securities, and national bonds and local bond certificates. Unused postage stamps, post cards, etc. Certificate stamps stipulated by law. Reproducing works forming the subject matter of copyright (literary works, musical works, paintings, engravings, maps, cinematographic works, drawings, photographic works, etc.) is not permitted unless the reproduction is for the purpose of personal use, family use or other similar uses within a limited circle.

Print Function

Item	Description
Type	Built-in type
Continuous Print Speed ¹	Same as the Basic Specifications / Copy Function
Print Resolution	600 x 600 dpi
Page Description Language	FX HBPL (Host Based Print Language)
Operation System ²	Windows® XP (32bit), Windows Server® 2003 (32bit), Windows Vista® (32bit) Windows Server® 2008 (32bit), Windows® 7 (32bit), Windows® 8 (32bit) Windows® 8.1 (32bit), Windows® XP Professional (64bit) Windows Server® 2003 (64bit), Windows Vista® (64bit) Windows Server® 2008 (64bit), Windows® 7 (64bit), Windows Server® 2008 R2 (64bit) Windows® 8 (64bit), Windows Server® 2012 (64bit), Windows® 8.1 (64bit) Windows Server® 2012 R2 (64bit)
Interface	USB2.0, Ethernet 100BASE-TX / 10BASE-T

*1: The speed may be reduced due to image quality adjustment. Print speed may also drop depending on the documents.
*2: Please refer to the Fuji Xerox web site for the latest supported operating systems.

Scan Function¹

Item	Description	
	DocuCentre S2520	DocuCentre S2320
Type	Colour Scanner	
Scan Resolution	600 x 600 dpi, 400 x 400 dpi, 300 x 300 dpi, 200 x 200 dpi	
Scan Speed ²	B / W : 28 ppm, Colour : 28 ppm [Fuji Xerox Standard Paper (A4 LEF), 200dpi]	B / W : 25 ppm, Colour : 25 ppm [Fuji Xerox Standard Paper (A4 LEF), 200dpi]
Interface	USB2.0, Ethernet 100BASE-TX / 10BASE-T	

*1: Scan to email performance is dependent on the SMTP server provided. Fuji Xerox recommends the use of a reliable SMTP service provider to ensure smooth performance of Scan to Email function.

*2: The scan speed varies depending on the documents.

Duplex Automatic Document Feeder

Item	Description	
	DocuCentre S2520	DocuCentre S2320
Original Size	Max : A3, 11 x 17", Min : A5	
Paper Weight	38 to 128 gsm (2 Sided) : 50 to 128 gsm)	
Capacity ¹	110 sheets	
Feeding Speed (A4 LEF Simplex)	25 ppm (A4 LEF, 1 Sided) 18 ppm (A4 LEF, 2 Sided)	23 ppm (A4 LEF, 1 Sided) 17 ppm (A4 LEF, 2 Sided)

*: When Using 80 gsm paper.



For Your Safety

Before using the product, read the Instruction Manual carefully for proper use. Use the product with the power source and voltage specified. Be sure to establish ground connection. Otherwise, electronic shock may result in the case of a failure or short circuit.



For more information or detailed product specification, please call or visit us at

Fuji Xerox Singapore Pte Ltd

80 Anson Road #01-01

Fuji Xerox Towers Singapore 079907

Tel. +65-6766-8888

<http://www.fujixerox.com.sg/>

